



Fairoak Close

Landare, CF44 8BT

£289,995



- ** DETACHED 3 BEDROOM FAMILY HOUSE
- ** HIGHLY SOUGHT AFTER LOCATION
- ** PRIVATE FRONT AND REAR GARDENS
- ** DRIVEWAY AND GARAGE
- ** ENTRANCE PORCH, EXCELLENT SIZE OPEN PLAN ENTRANCE HALL.
- ** DOWNSTAIRS CLOAKROOM. 2 RECEPTION ROOMS. FITTED KITCHEN
- ** FIRST FLOOR 3 GOOD SIZE BEDROOMS AND FAMILY BATHROOM
- ** GAS CENTRAL HEATING. UPVC DOUBLE GLAZED WINDOWS AND DOORS

Early viewing is recommended on the spacious well established 3 bedroom detached house situated in a perfect location within easy walking distance of local schools, Dare Valley Country Park with excellent country walks.



Entrance Porch 4'6 x 6'6 (1.37m x 1.98m)

Upvc double glazed widows and door. Tiled floor.

Open Plan Hallway 14'2 x 10'6 (4.32m x 3.20m)

Large picture double glazed windows overlooking front garden. 2 x deep storage cupboards.

Downstairs Cloakroom

Modern suite comprising w.c., and wash hand basin. Part tiled walls. Upvc double glazed window to side aspect. Radiator.

Lounge 10' x 18'2 (3.05m x 5.54m)

Upvc double glazed picture window to rear aspect. Upvc double glazed window to front aspect. Radiator.

Dining room 12'5 x 11' (3.78m x 3.35m)

Tiled floor. Upvc double glazed patio windows to rear garden.

Fitted kitchen 14'4 x 7'7 (4.37m x 2.31m)

With a modern range of wall and base units, ceramic 1 1/2 bowl sink unit. Pantry cupboard. Radiator. Tiled floor. Upvc double glazed window to rear aspect. Door to rear garden.

landing

Upvc double glazed window to front aspect.

Bedroom 1 13'5 x 9'5 (4.09m x 2.87m)

Radiator. Twp double built in wardrobes. Upvc double glazed window to rear aspect.

bedroom 2 9'11 x 14'6 (3.02m x 4.42m)

Radiator. Upvc double glazed window to rear aspect. Built-in wardrobe.

bedroom 3 7'11 x 10' (2.41m x 3.05m)

Radiator. Upvc double glazed window to front aspect.

Bathroom 5'10 x 8'5 (1.78m x 2.57m)

Modern suite comprising bath, wash hand basin and w.c., radiator. Part tiled walls. Upvc double glazed window.

Garage

Up and over door, power and light connected.

outside

Entrance drive. Front garden with paved patio mainly laid to lawn with private hedge surrounding front and rear gardens.

Tenure

Freehold so we are advised by vendor.

Disclaimer

N.B Whilst these particulars are intended to give a fair description of the property concerned, their accuracy is not guaranteed and any intending purchaser must satisfy himself by inspection or otherwise, as to the correctness of statements contained herein.

The particulars do not constitute an offer or contract, and statements herein are made without responsibility, or warranty on the part of the Vendor or Manning Estate Agents, neither of whom can hold themselves responsible for expenses incurred should the property no longer be available. Items shown in photographs are NOT included unless specifically mentioned in particulars. They may however be available by separate negotiation.

The Property Misdescription Act 1991

The Agent has not tested any apparatus, equipment, fixtures and fittings or services and so cannot verify that they are in working order or fit for the purpose. A buyer is advised to obtain verification from their Solicitor or Surveyor. References to the Tenure of the property are based on information supplied by the seller. The Agent has not sight of the title documents. A Buyer is advised to obtain verification from their Solicitor.

You may download, store and use the material for your own personal use and research. You may not republish, retransmit, redistribute or otherwise make the material available to any party or make the same available on any website

These particulars, whilst believed to be accurate are set out as a general outline only for guidance and do not constitute any part of an offer or contract. Intending purchasers should not rely on them as statements of representation of fact, but must satisfy themselves by inspection or otherwise as to their accuracy. No person in this firms employment has the authority to make or give any representation or warranty in respect of the property.

Gloucester House, 29 Whitcombe Street, Aberdare, CF44 7AU
Tel: 01685 878000 Email: info@manningestateagents.co.uk https://www.manningestateagents.co.uk

Area Map



Floor Plans

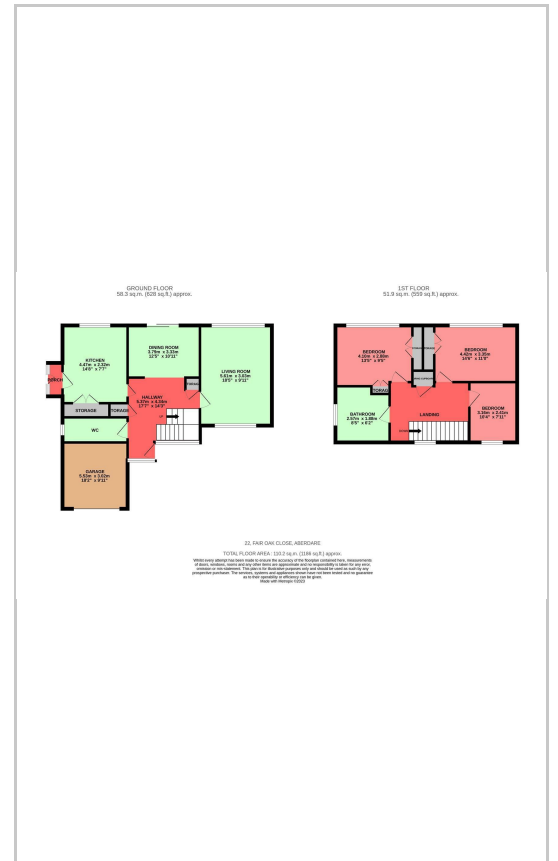

Energy Efficiency Graph

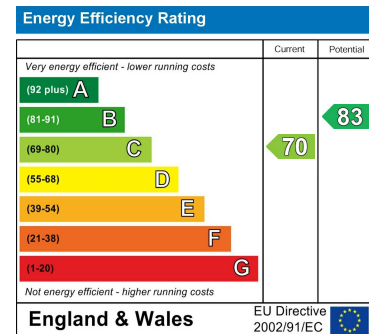

Gloucester House, 29 Whitcombe Street, Aberdare, CF44 7AU
Tel: 01685 878000 Email: info@manningestateagents.co.uk https://www.manningestateagents.co.uk